

FROM
VISION
TO REALITY

Excellent employer

57,75
①



Schrack Seconet Fire Alarm Systems.

Worldwide security.

FIRE ALARM

SCHRACK
SECONET

Overview.



Integral IP family

MX, CX, BX



CUBUS technology

New standards in detection



BX-MDH

Door holding magnet



IP Applications

for Fire Alarm Systems



Integral LAN

Examples and references

Integral IP system family.



- **M**odular, decentralized structure
- 100% redundant system
- can be TCP/IP networked
- **X**-LINE capable: up to 16 loops or 4,000 elements per control unit
- Multizone extinguishing system control panel



- **C**ompact, decentralized structure
- Software redundancy
- can be TCP/IP networked
- **X**-LINE capable: up to 4 loops or 1,000 elements per control unit
- Single zone extinguishing system control panel

Integral IP BX - intelligent new 1-Loop Panel.

Interfaces

1x Loop X-LINE (max. 250 elements),

1x LAN (100Mbit-TX)



Double security thanks to real redundancy.

- **Two** identical **systems** work constantly in "Hot-Stand-By-Operation"
- Not only the microprocessor structure, but **all** other system structures, components and parts are also **duplicated**
- The occurrence of a fault in the active section of the system causes the system to be **automatically switched over** to the second side of the system and for a system fault to be indicated

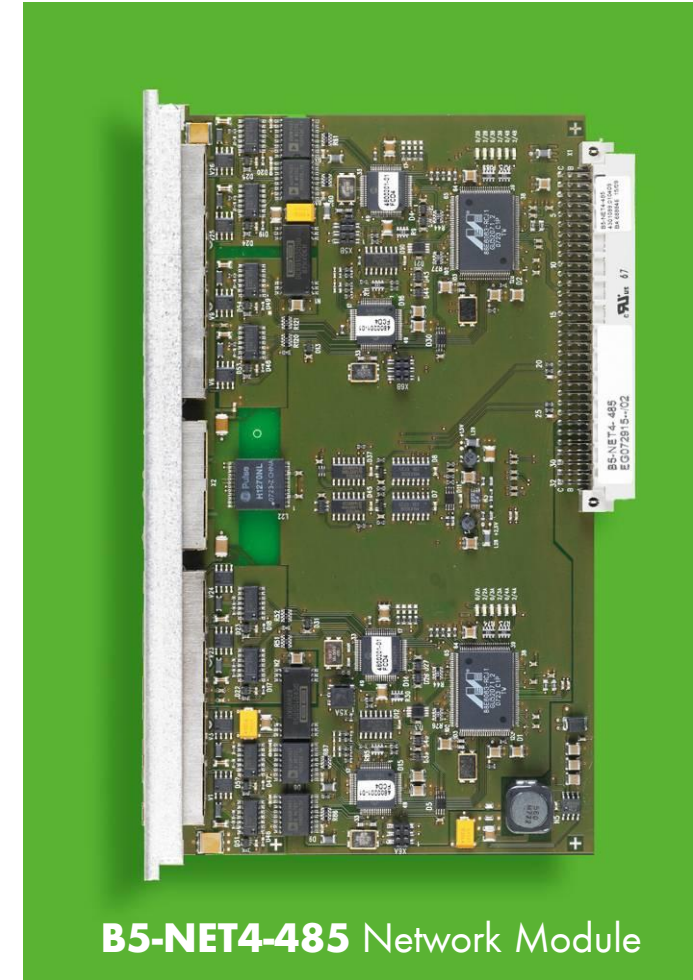

Integral X-LINE.

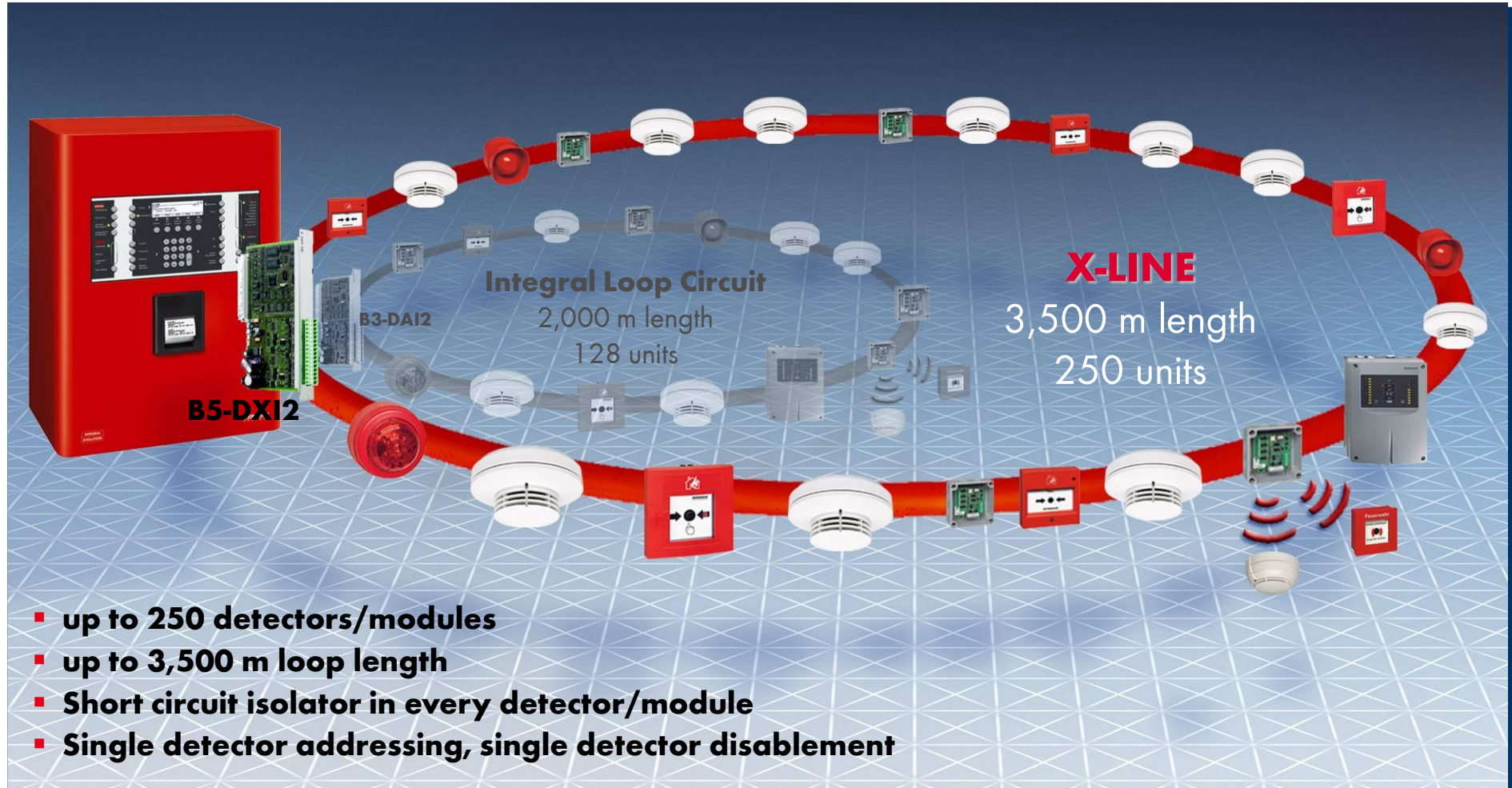

CUBUS technology - New standards in detection.



Multiple Sensor Detector MTD 533.

- **ONE** fire detector **for all** applications
- **Automatically adapts** to its surrounding conditions
- Mechanically and electronically backward compatible



CUBUS Technology.

- The detector **adjusts itself automatically** according to its ambient conditions
- The detector **monitors the ambient temperature** as well as the **relative increase of temperature** and automatically **calculates the optimal smoke sensitivity** for each location.
- Thanks to CUBUS technology **deceptive alarms can be reduced**

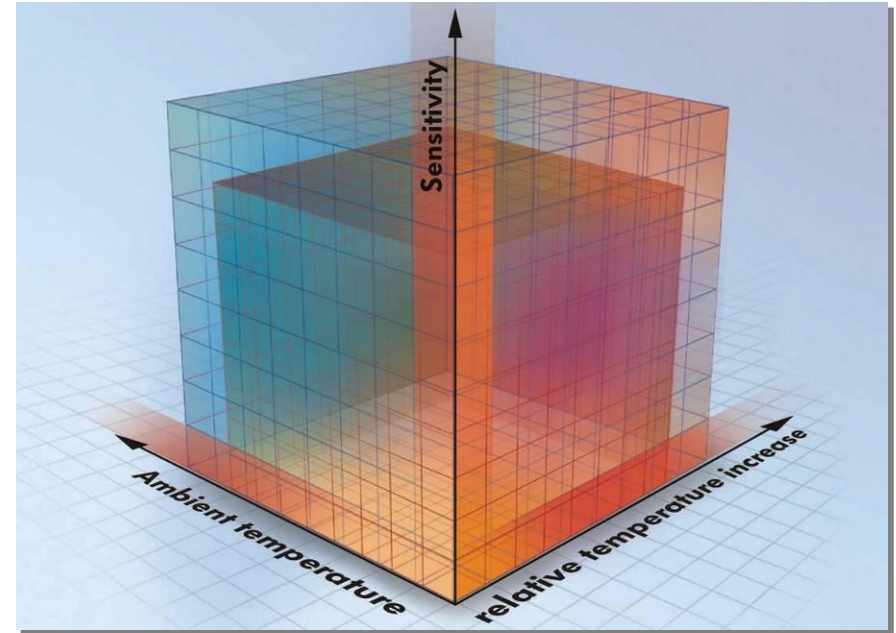



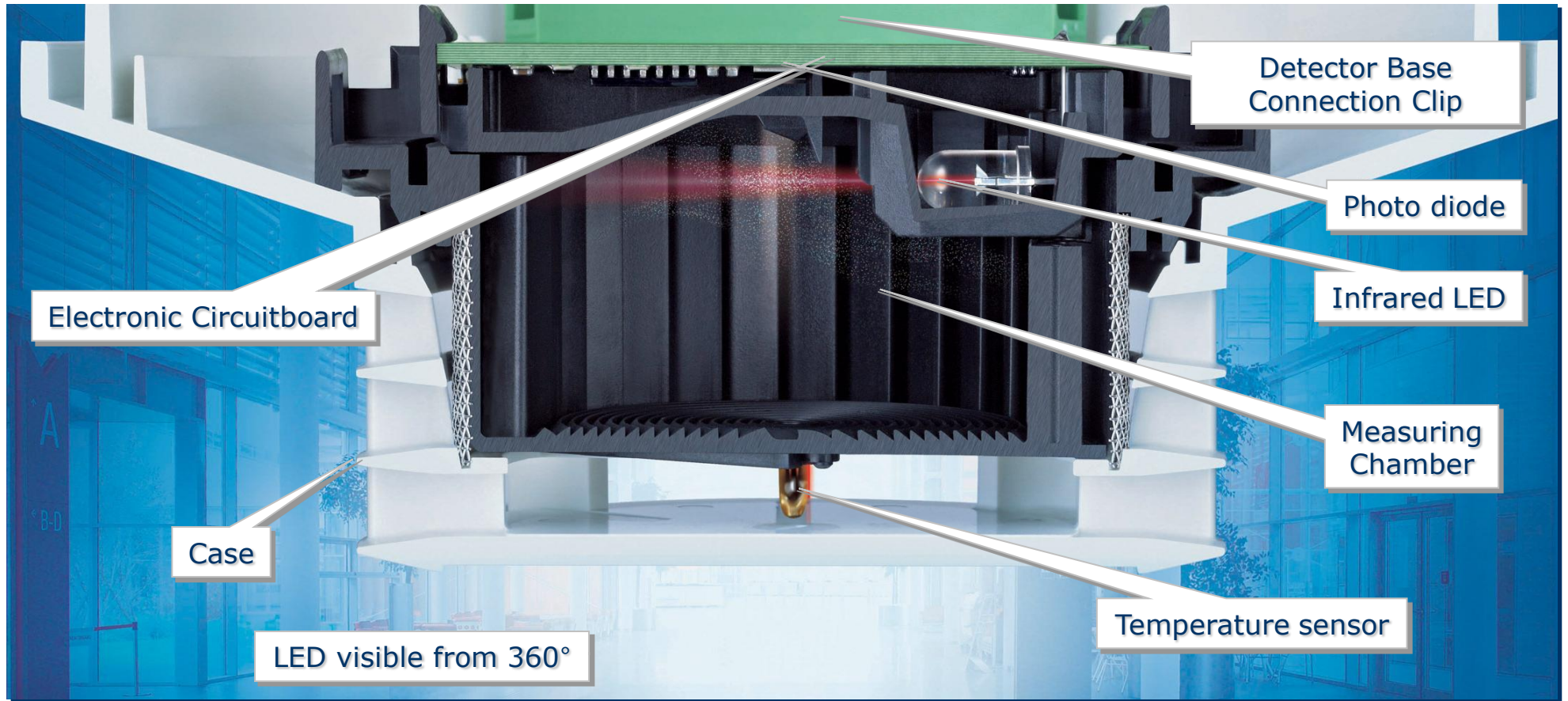

New standards in detection.

- **Multisensor detectors**
for all applications
- **CUBUS technology**
for intelligent detection
- **Compliant with all new EN standards**
 - prEN 54-26:2008
Point fire detectors using **carbon monoxide** sensors
 - prEN 54-30:2009
Point detectors using a combination of carbon monoxide and heat sensors
 - prEN 54-31:2012
Point detectors using a combination of smoke, carbon monoxide and optionally heat sensors
 - prEN 54-29:2009
Point detectors using a combination of smoke and heat sensors

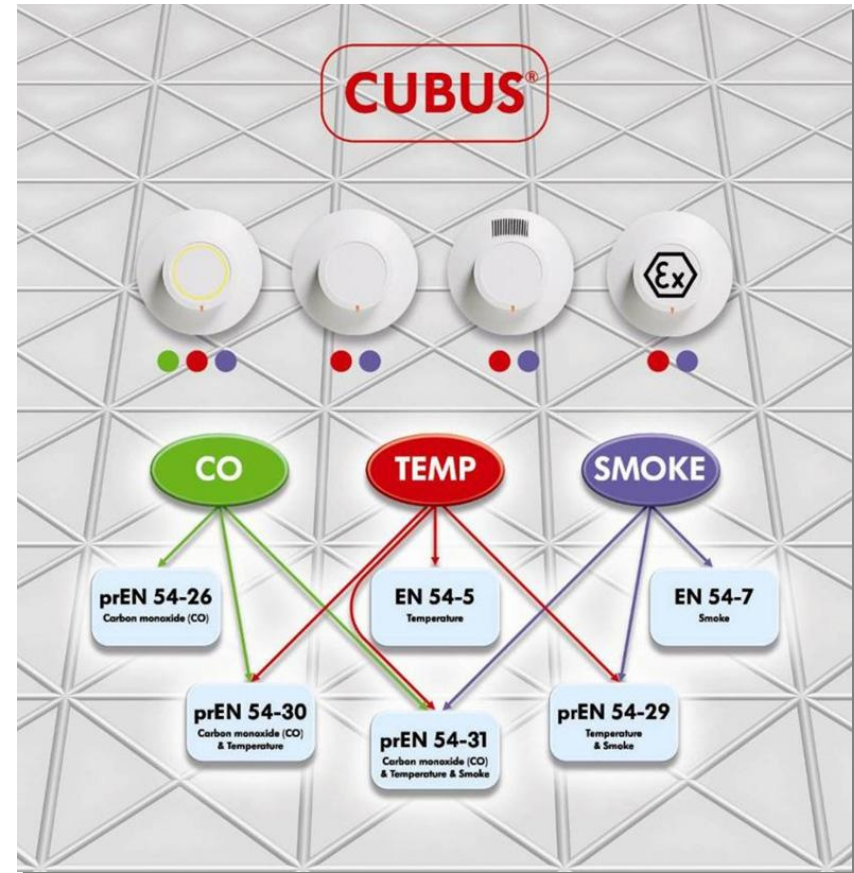

CMD 533X

carbon monoxide



MTD 533X-S/SP

siren / speaker integrated



Green building door holding magnet BX-MDH.



Door holding magnet BX-MDH.

- directly on loop
- saves energy costs,
no continuous current required
- permanent magnet
- integrated monitoring of the
door position



Door holding magnets – standard installation.

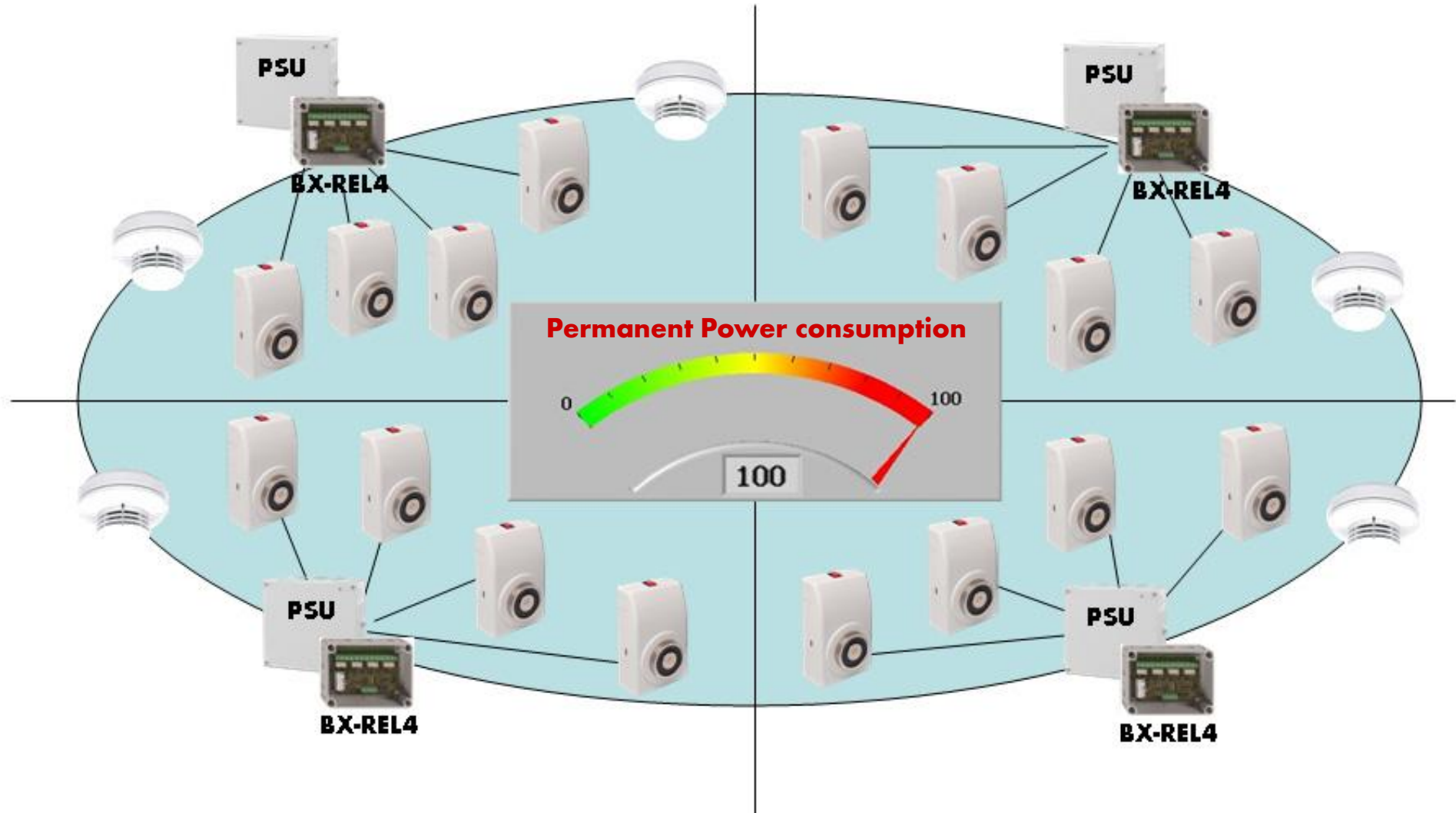

New door holding magnet BX-MDH.

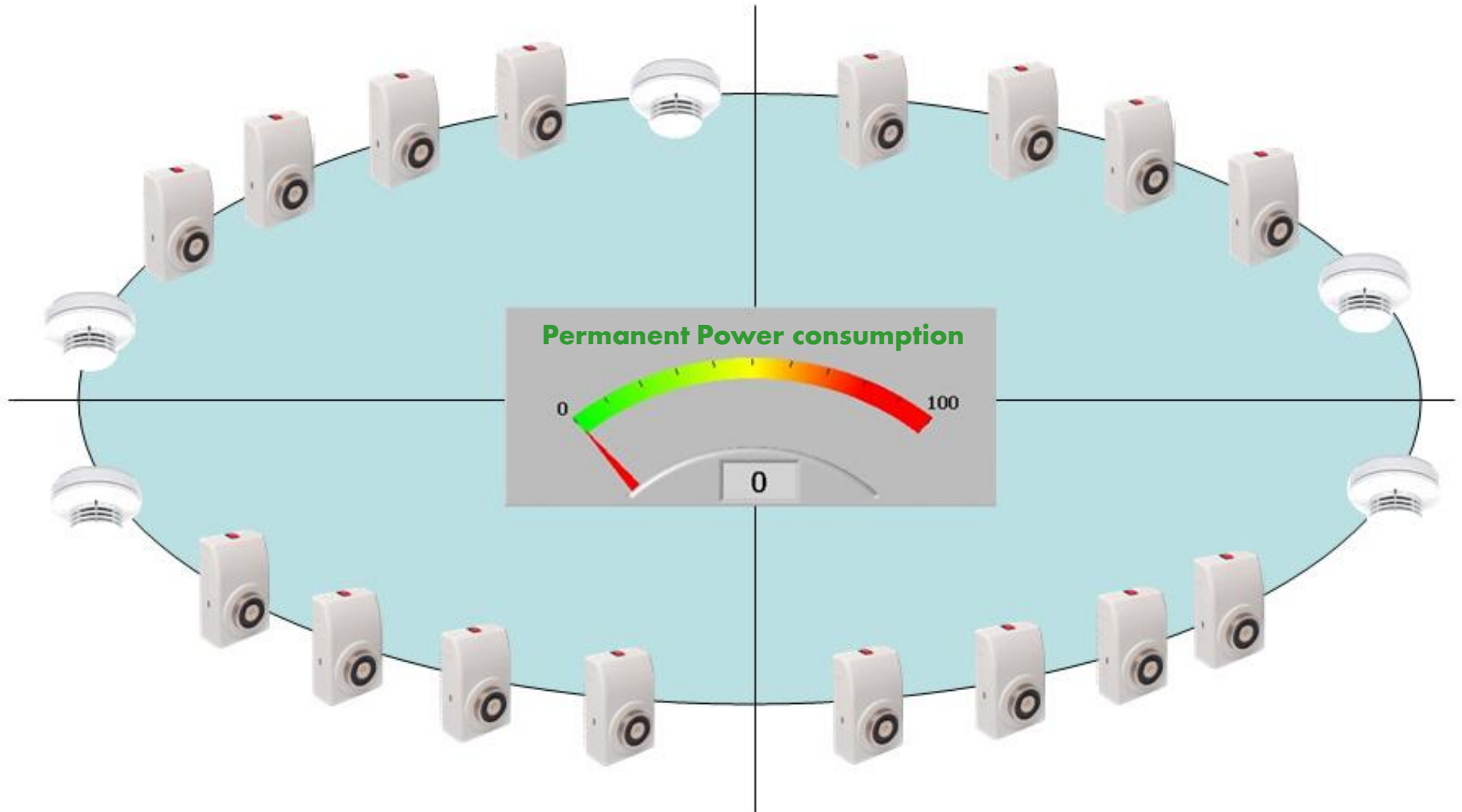

IP Applications for Fire Alarm Systems.



Integral IP Network.

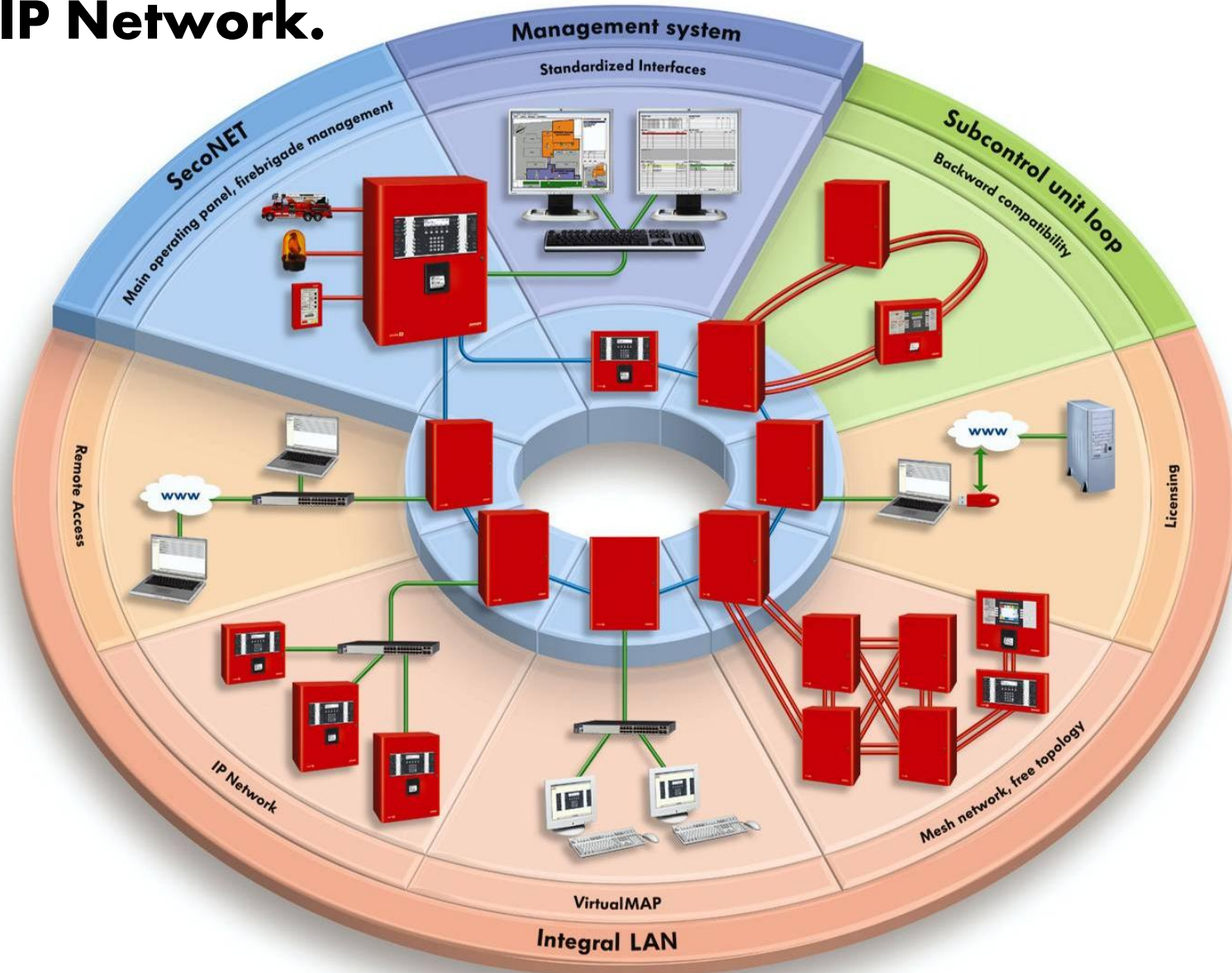

Integral IP Applications - Overview.



Get informations

Operating the system

Programming

Integral over IP – Applications & Benefits.

- **Use of existing networks**
(Intranet, Internet)
- **Standard interfaces** (LAN, IP)
- **Messaging:** Panels send information's automatically to responsible persons
- **Immediate intervention** of specialists **possible from anywhere**

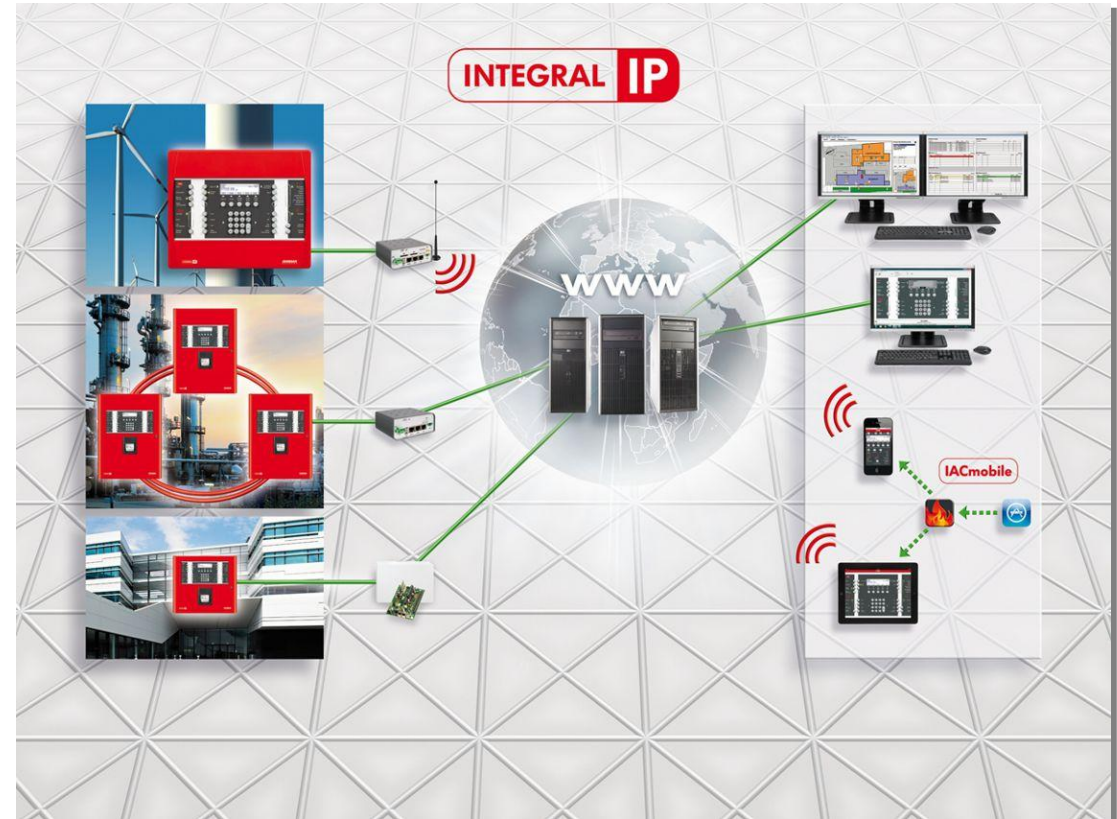

Integral over IP – PC terminal devices.

▪ **RemoteMESSAGE**

Automatic messages from control panels to a Server and visualisation on PCs.

▪ **Integral MAIL**

Information: the control panels send event-based emails to recipients



Integral over IP - PC terminal devices.

- **Integral VirtualMAP**

Virtual operating control panel on PC



- **IAC RemoteACCESS**

Support during start-up procedure, assistance in troubleshooting, remote reprogramming



Integral over IP - PC terminal devices.

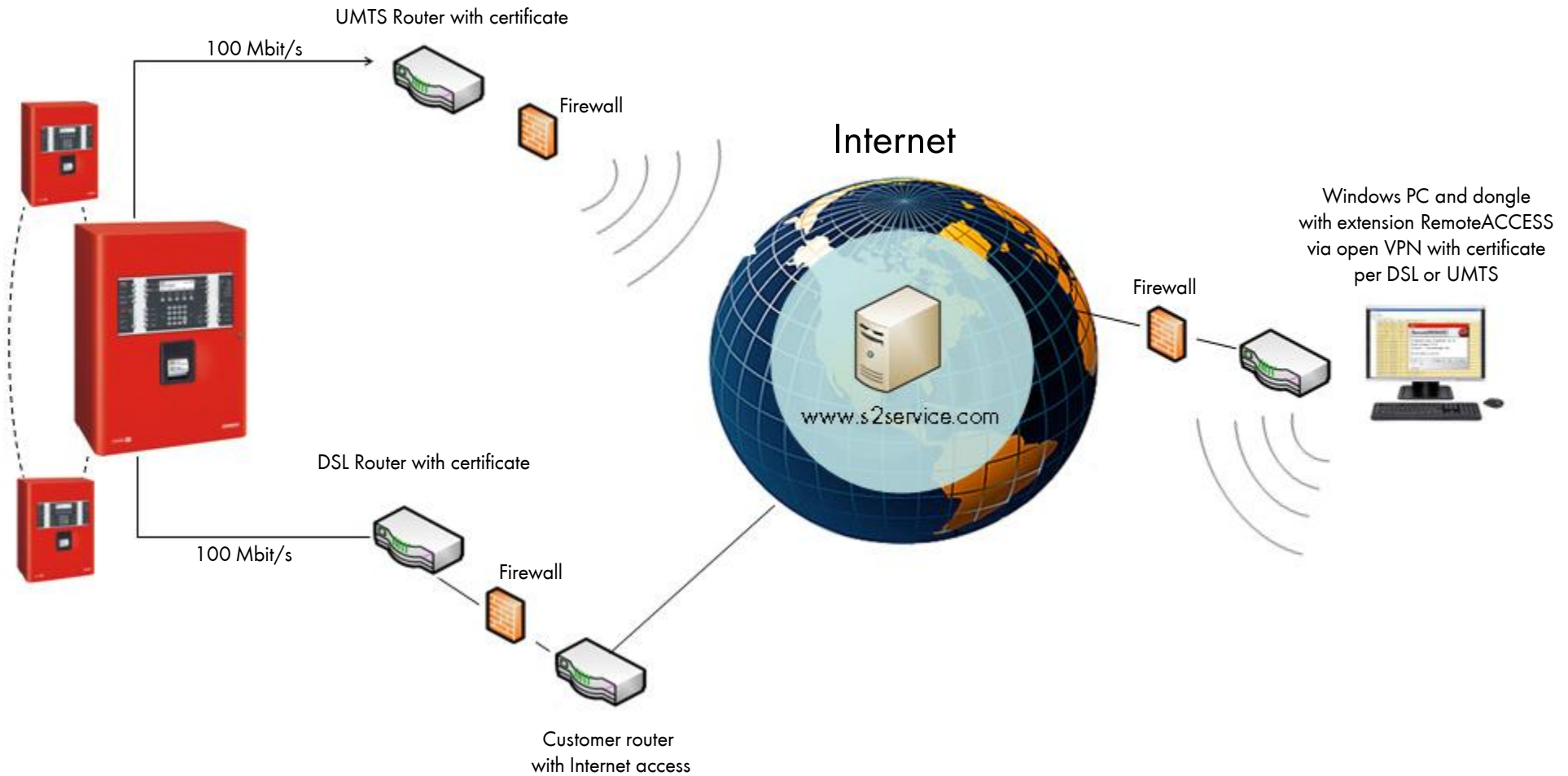

Integral over IP - Mobile devices.

- indication and operation of fire alarm panels independent of location of the user
- Indicates information about the current state of the system
- Remote help
- Push-Notifications
- Geodata query



Integral over IP - Mobile devices.

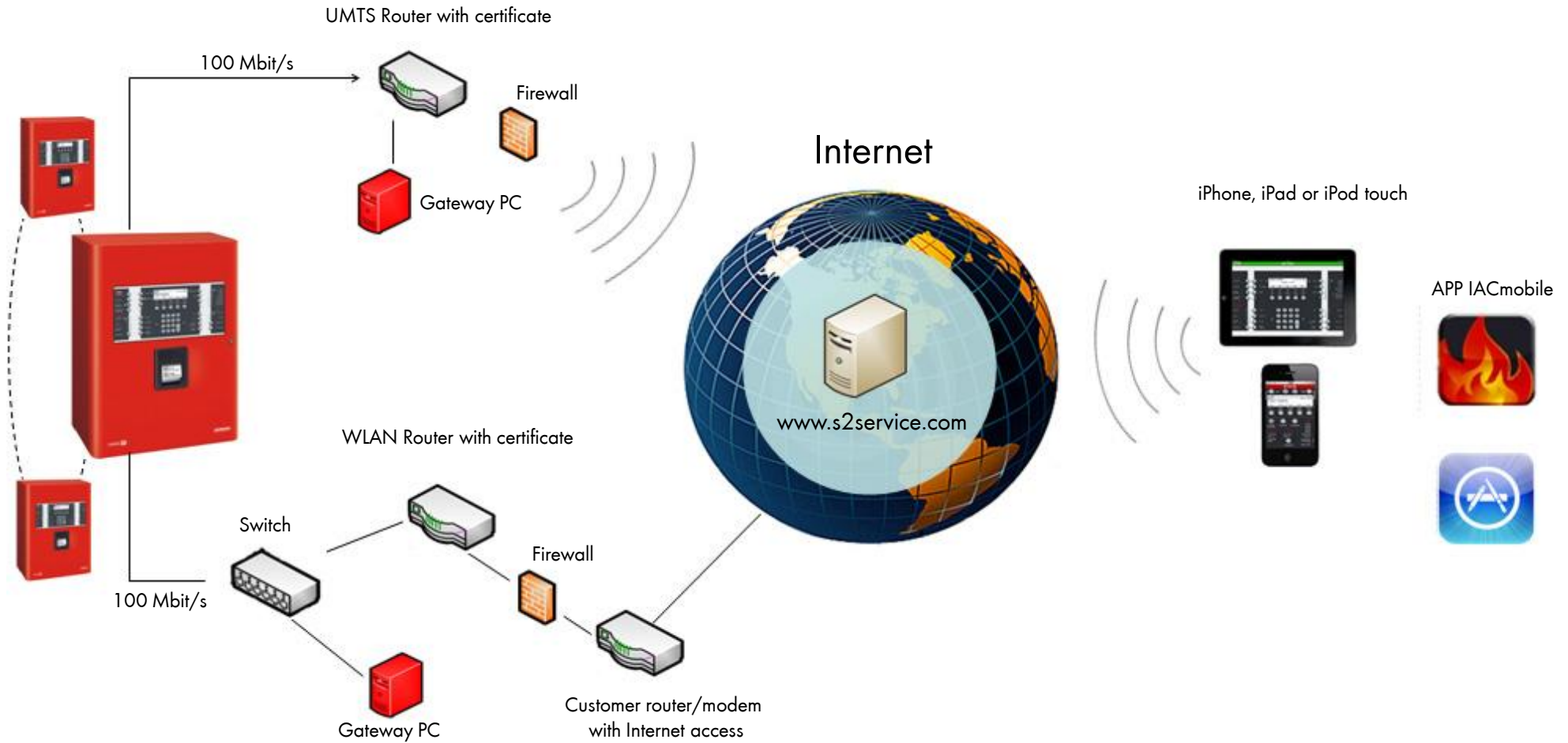

Safety for tourism, small industry and unattended objects.

- Bank branches
- Supermarkets
- Gas stations
- Pumping stations of pipelines
- Transformer stations



Example for protecting unattended equipment.



Integral LAN – Example for shopping center.

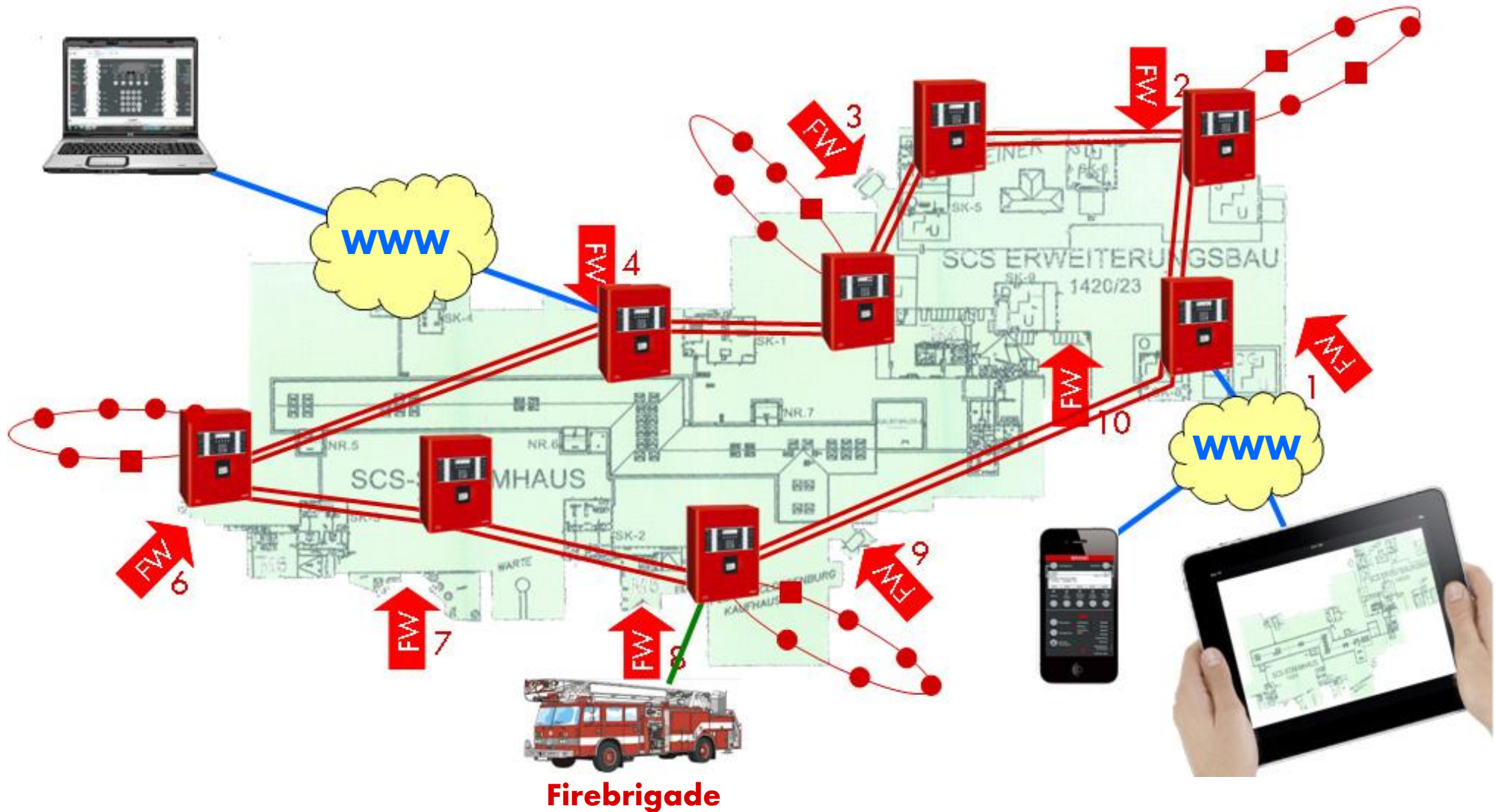

Integral LAN – Example for distributed industries.



Integral over IP projects

- ⇒ Bulgaria:
 - **29 H&M** shops with Integral BX
 - **centralized service access**
 - Remote Message
 - IAC/Virtual Map, E-Mails, Internet, S2S

- ⇒ Turkey:
 - Botas Refinery
 - Integral IP MX in network with **existing LAN Intranet**

- ⇒ Israel:
 - **80** Mizrachi bank shops with Integral BX
 - Virtual Map, Remote Message, Intranet

Integral over IP projects

⇒ India: **186** water pumping stations with **Integral BX, Remote Message, Intranet** (Offer phase)

⇒ Romania: APA Nova waste water treatment Bukarest

- 12 panels B6/B7 in 5 different locations
- Intranet, Remote Message/E-Mail
- Secolog IP with 3 clients

Numbers

- Over **6000 central units** / year are delivered to projects in Europe, Africa and Asia
- Is compatible with 3 past generations of fire alarm systems dating back to the year 1985.
- Currently in the airport of Vienna approximately **59.000 detectors are integrated in a network of 76 central units.**

Advantages for you!

- **Experienced partners**
- **Direct connection to “IP world”** → IP applications, MAIL, SMS, Push notifications to smartphones and tablet PCs
- **Full Redundancy, shortcut isolator, one intelligent detector, one system family** for all different dimensions of projects

